

- SYMBOL KEY:
- CB CATCH BASIN
 - CC CURB CUT
 - DI DRIVE-IN DOOR
 - HYDRANT FIRE HYDRANT
 - SIGN BUILDING SIGN
 - TC TRASH COMPACTOR
 - TD TRUCK DOCK
 - TRANS ELECTRICAL TRANSFORMER
 - TRASH TRASH ENCLOSURE
 - USPS MAIL BOX

KEY	COON RAPIDS SQUARE
1	Suite 3005
2	Suite 3015
3	Suite 3017
4	Mech
5	Suite 3021
6	Suite 3023
7	Suite 3027
8	Suite 3029
9	Suite 3033
10	Suite 3037
11	Suite 3045
12	Suite 3053
13	Suite 3059
14	Suite 3061
15	Suite 3065
16	Suite 3067
17	Elect
18	Suite 3071

AREA CALCULATIONS *	
PARKING SPACES	336
PARKING LOT	152,788 SF
WALKS	14,954 SF
LANDSCAPE - GRASS	21,014 SF
LANDSCAPE - PLANTED (MULCH)	15,110 SF
LANDSCAPE - NATURAL	22,487 SF

*Area Calculations are Approximate

COON RAPIDS SQUARE

3005-3071 COON RAPIDS BLVD., COON RAPIDS, MN 55433

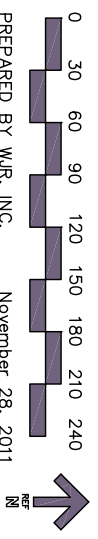

PREPARED BY WJR, INC.

November 28, 2011

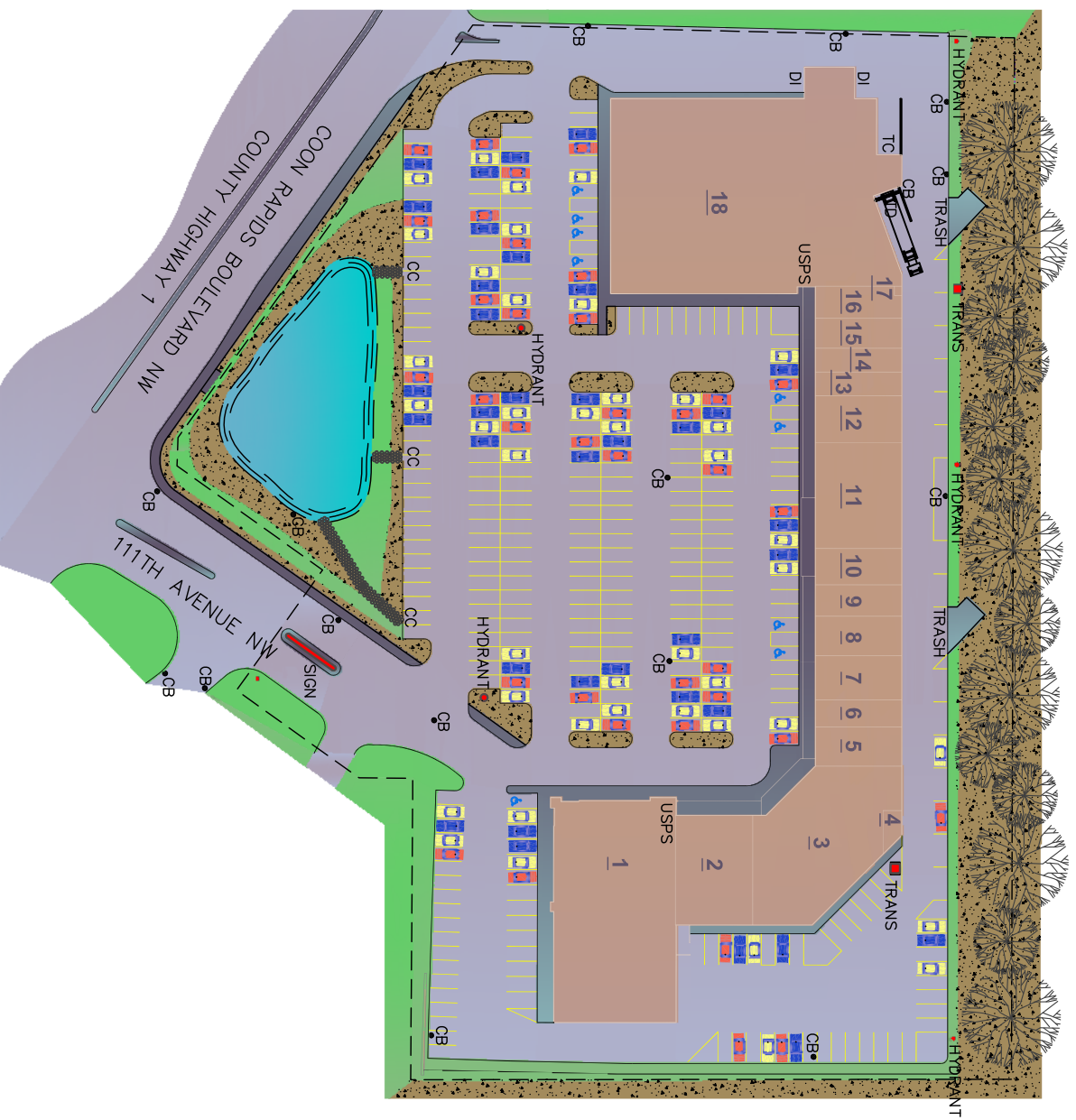

Wellington

MANAGEMENT, INC.

1625 Energy Park Dr., Suite 100
 St. Paul, MN 55108
 Tel: 651-992-9844 Fax: 651-992-0072