

Valley Creek Mall & Annex

1740 & 1750 Weir Drive
Woodbury, MN 55125



WELLINGTON
MANAGEMENT



Vicki Karr
651-999-5537
vkarr@wellingtonmgt.com



Destination shopping center with a local focus.

Valley Creek Mall is Woodbury’s only indoor shopping center and a longtime community anchor. Wellington acquired the two-building complex (an indoor mall and a strip mall) in 1994 and completed an extensive renovation to revitalize the mall, originally built in the ‘70s. Today, Valley Creek Mall is home to 25+ retail tenants, with a strong presence of locally owned and operated businesses.

These small businesses bring both unique offerings and a high level of service to the area. Keys Café remains Minnesota’s most-awarded family-owned café and bakery, Frattallone’s Hardware has served Woodbury for many years, and local, family-owned Warners’ Stellan offers an array of home appliances and exceptional customer service. As of 2020, family-owned “community kitchen” Andiamo serves fine Italian cuisine in a beautifully outfitted space.

HIGHLIGHTS

- Well-established community anchor with 25+ retail tenants
- Located at the intersection of Valley Creek Road and I-494
- Anchor tenants include Frattallone’s Hardware, Keys Café and Bakery, Andiamo, Warners’ Stellan, Birdi Golf and Minnesota School of Cosmetology
- More than 30 events each year sponsored by active merchants association

Space Available

Owner, Manager, Leasing
96,048 SF; 1,690 SF available
500 surface stalls, 5.2 : 1,000 SF
Single-story retail buildings
Built in 1974 & 1985
East Metro

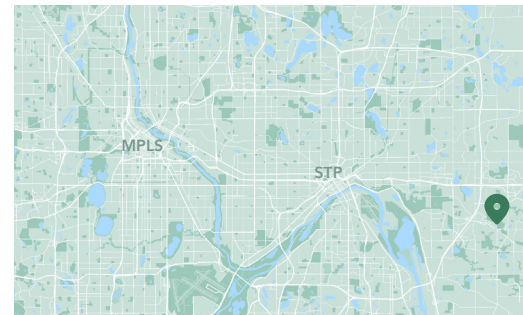

Floor Plans - Mall

- Building Common Areas
- Available Space
- Occupied Space

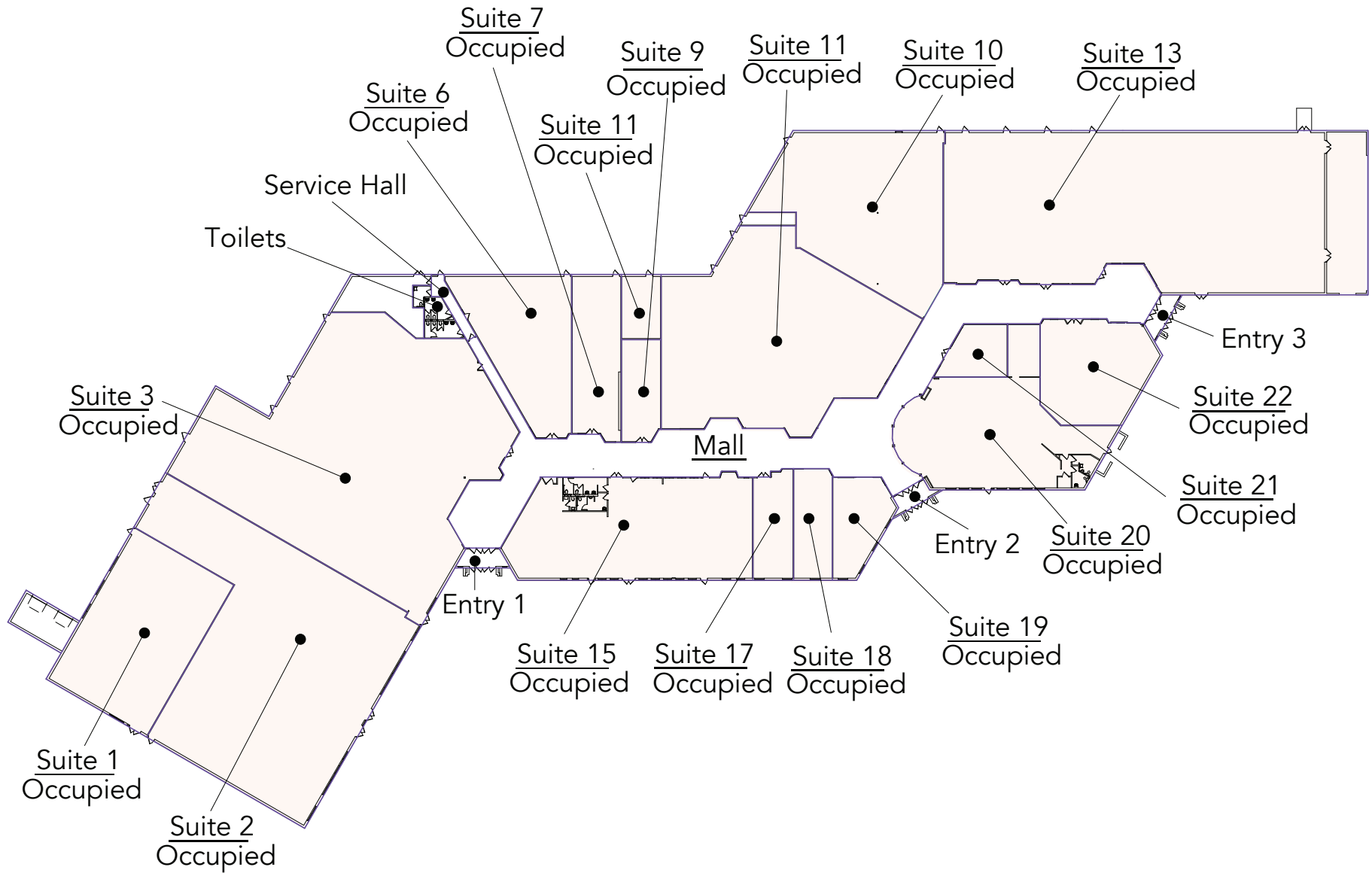

Floor Plans - Annex

- Building Common Areas
- Available Space
- Occupied Space

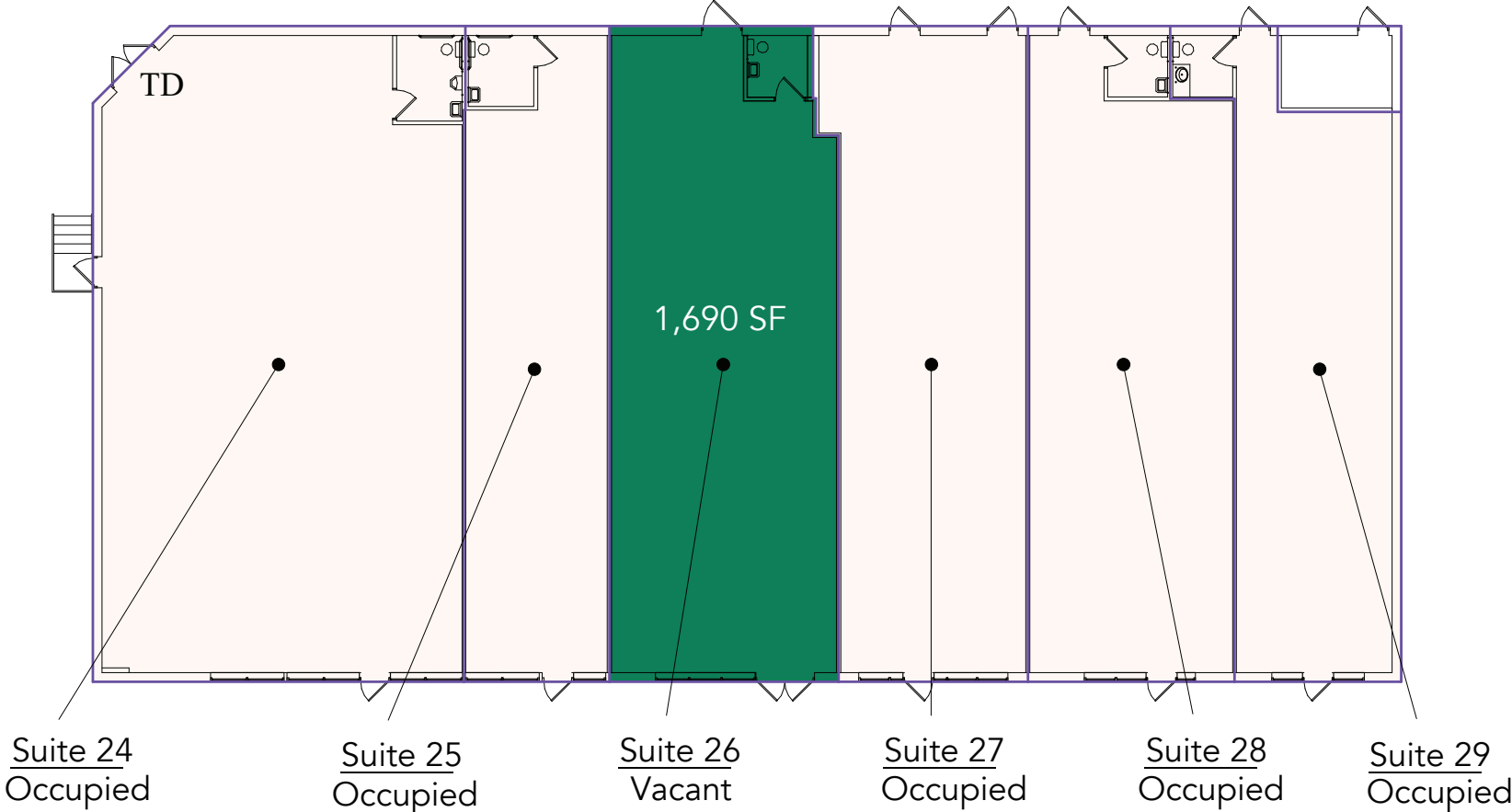

Site Plan



Valley Creek Mall & Annex

1740 & 1750 Weir Drive
Woodbury, MN 55125



PROPERTY MANAGER
LEASING AGENT

Vicki Karr

651-999-5537
vkarr@wellingtonmgt.com



St. Paul-based Wellington Management, Inc. owns, manages and develops commercial and residential properties throughout the Twin Cities metro area. We work to make long-term community impact through careful district planning and neighborhood relationships.

Main (651) 292-9844
Fax (651) 292-0072
wellingtonmgt.com

Wellington Management © 2021 All rights reserved.